

305 | Expo Roll-Up, double sided

TECHNICAL GUIDE

We recommend
200-310 g
polyester
bannermaterial



GB Roll-up with flexibel height. Produced in silver anodized aluminium. Solid construction and very nice design. Clamp profiles in top and strong tape on the bottom paper roll makes the mounting of the material easy. New tape must be mounted when changing the material. Black luxury bag incl. Delivered without banner. Packed with 4 pcs.

DE Roll-up mit variable Höhe - aus silber-eloxiertem Aluminium hergestellt. Kräftige Konstruktion im stilgerechten Design. Das Klebeband an der Rolle sowie die Klemmleiste oben, ermöglicht eine leichte Montage des Banners. Beim Wechseln des Banners muß neues Klebeband an der Rolle montiert werden. Inkl. kräftige schwarze Luxus Tragetasche. Wird ohne Banner geliefert. 4 Stück pro Karton.

DK Roll-up med variabel højde - udført i søveloxeret aluminium. Kraftig konstruktion i stilrent design. Topprofiler med klemmleiste og kraftig 3M tape på bundrulle gør, at det er let at montere banneret. Ved udskifning af budskab skal der monteres ny tape. Inkl. kraftig sort luxus bæretaske. Leveres uden banner. Pakket med 4 stk. pr. karton.

Graphic dimensions:

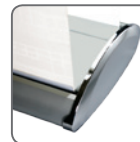
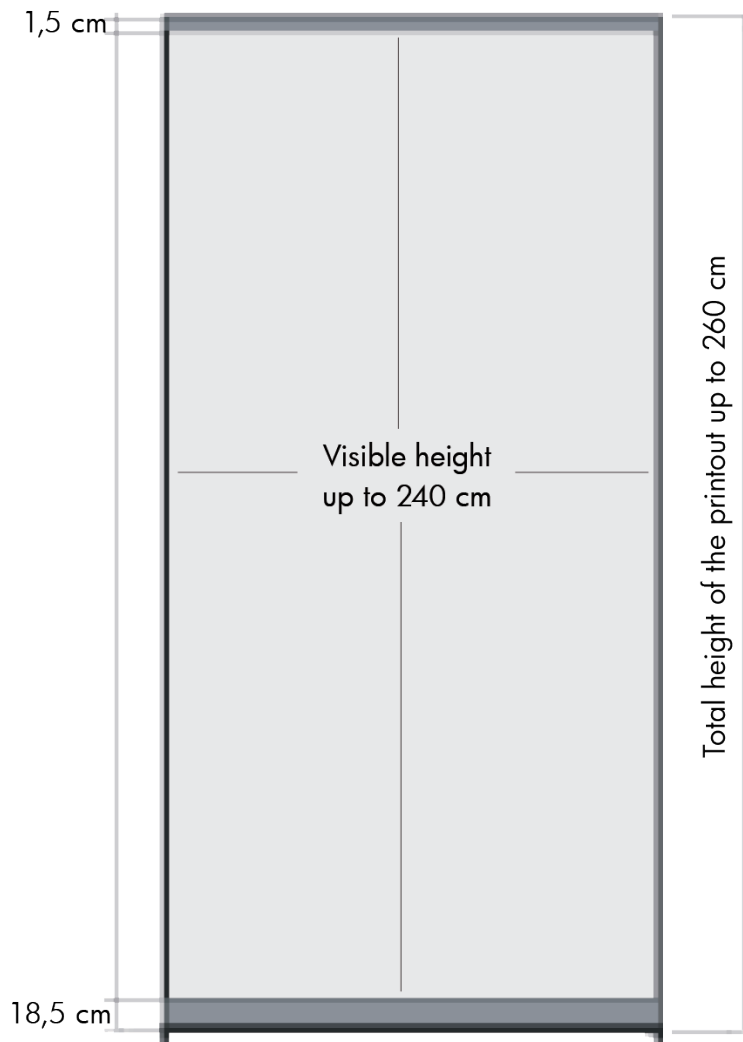

1 Make the front side of the graphic down on the desk, open the graphic clip to a suitable angle, then insert the top of graphic into the gap. Be sure to make tightly and right in order.

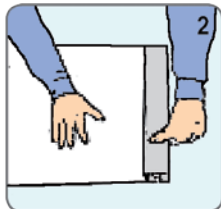

2 Make the flexible clip back until it is flat. Lock the graphic tightly.

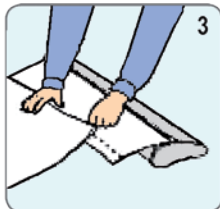

3 Make the front side of the graphic up and the back of roll-up up, put the leading paper in good place, tore down the double-glue film, make the back of graphic glue to it. **Notice:** When gluing, make it right in line with the black parallel.

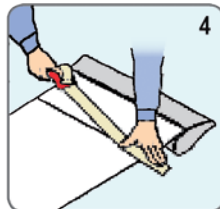

4 Apply the glue tape to the joint between graphic and leading paper, firm it better.

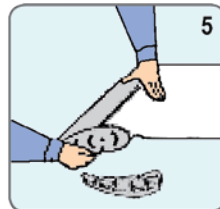

5 Press the graphic with strength by hand, meantime, press the roll-up body. Pull the graphic out slightly, loose the lock latch and pull it out completely. **Notice:** Avoiding the graphic scrolling instantly.

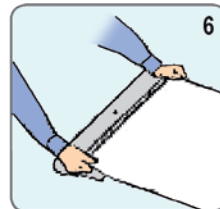

6 Loose the hand pressing the graphic, but do not leave the graphic. Make it scroll gradually and adjust it while scrolling until the whole graphic smoothly scrolling in.

Art.no.	Bannersize	- visible part	Colour	Total W x H	Package Size	- weight	Pallet size	- quantity
4589	56 x 216 - 260 cm	56 x 196 - 240 cm	Alu	63 x 206 - 250 cm	13 x 70 x 25 cm	5,3 kg	80 x 120 x 220 cm	66 pcs.
4590	83 x 216 - 260 cm	83 x 196 - 240 cm	Alu	90 x 206 - 250 cm	13 x 94 x 25 cm	6,7 kg	80 x 120 x 220 cm	50 pcs.
4591	96 x 216 - 260 cm	96 x 196 - 240 cm	Alu	103 x 206 - 250 cm	13 x 103 x 25 cm	7,5 kg	80 x 120 x 220 cm	32 pcs.
4592	116 x 216 - 260 cm	116 x 196 - 240 cm	Alu	123 x 206 - 250 cm	13 x 127 x 25 cm	8,6 kg	80 x 120 x 220 cm	28 pcs.
4514	Spotlight 50 W		Alu		8 x 7 x 46 cm	0,4 kg	80 x 120 x 220 cm	400 pcs.